

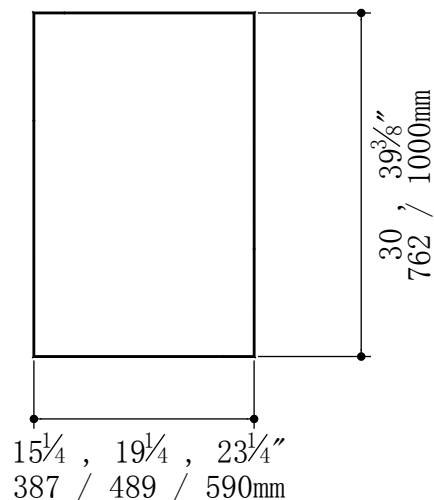

M Series Medicine Cabinet

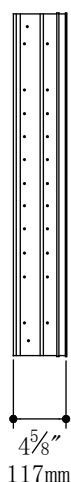

Tools required for proper installations

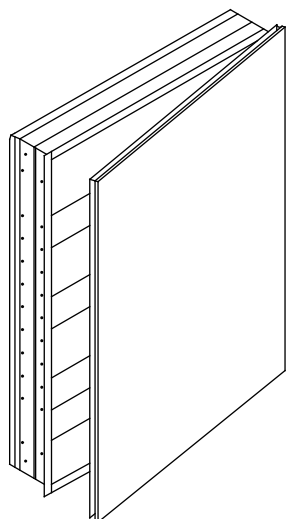
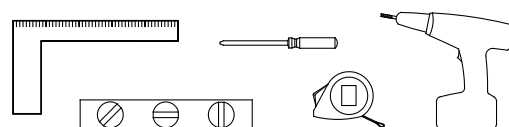

Parts

Please locate and be sure all parts are present prior to installation.

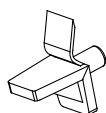

(12) Shelf Clips
(A)



(40) Hole Plugs
(B)



(4) Screw Caps
(C)

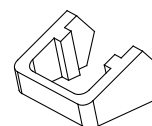

(2) Reduction Clips
(D)

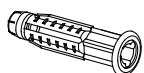

(6) Anchors
(E)



(6) Screws
(F)

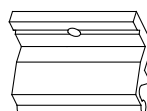

(2) Mounting Clips
(G)



(1) Mounting Bar
(H)

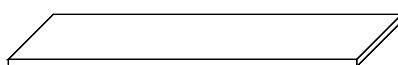

(3) Glass Shelves
(I)

Recess Mounting Instructions

Recommended:

- I . Remove cabinet door and store safely prior to installation.
- II . **DO NOT REMOVE** corner guards from door until installation is complete.

1. Depending on size of the cabinet make the according rough opening box for affixing

Model	Size	Rough-in Open
_ M1630	15- $\frac{1}{4}$ " x 30"	RO: 14- $\frac{1}{2}$ " x 29- $\frac{1}{4}$ " x 4"
_ M2030	19- $\frac{1}{4}$ " x 30"	RO: 18- $\frac{1}{2}$ " x 29- $\frac{1}{4}$ " x 4"
_ M2430	23- $\frac{1}{4}$ " x 30"	RO: 22- $\frac{1}{2}$ " x 29- $\frac{1}{4}$ " x 4"
_ M1640	15- $\frac{1}{4}$ " x 39- $\frac{3}{8}$ "	RO: 14- $\frac{1}{2}$ " x 38- $\frac{5}{8}$ " x 4"
_ M2040	19- $\frac{1}{4}$ " x 39- $\frac{3}{8}$ "	RO: 18- $\frac{1}{2}$ " x 38- $\frac{5}{8}$ " x 4"
_ M2440	23- $\frac{1}{4}$ " x 39- $\frac{3}{8}$ "	RO: 22- $\frac{1}{2}$ " x 38- $\frac{5}{8}$ " x 4"

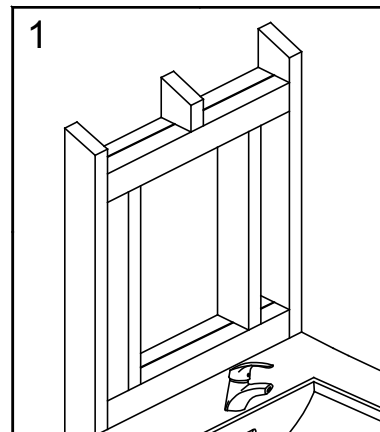

2. Make sure to leave sufficient clearance from the top of the faucet at least 1" is recommended.

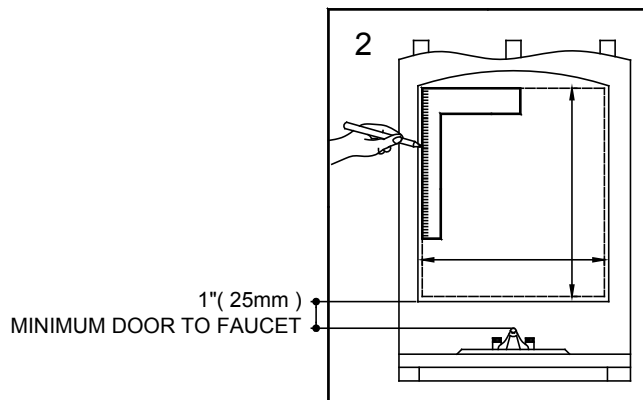

3. Place cabinet inside of rough opening box and be sure to check that is it level.

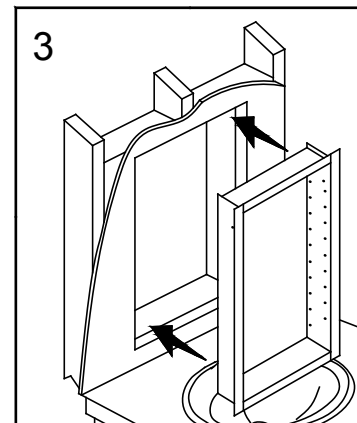

4. Install Screw (F) in the mounting holes provided.

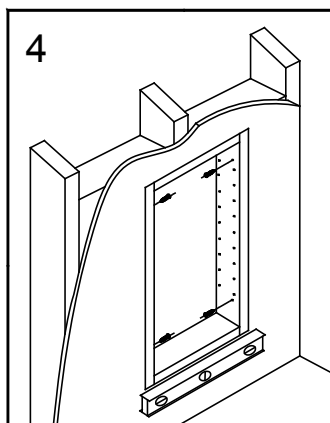

Surface Mount Instructions

Recommended:

- I . Remove cabinet door and store safely prior to installation.
- II . **DO NOT REMOVE** corner guards from door until installation is complete.

1. Making a housing support box for the cabinet is recommended to help keep cabinet sturdy and provide proper support during the installation process.
2. Center mounting bar (H) to the bottom of the cabinet. Be sure to leave sufficient clearance for the faucet at least 1 " is recommended.

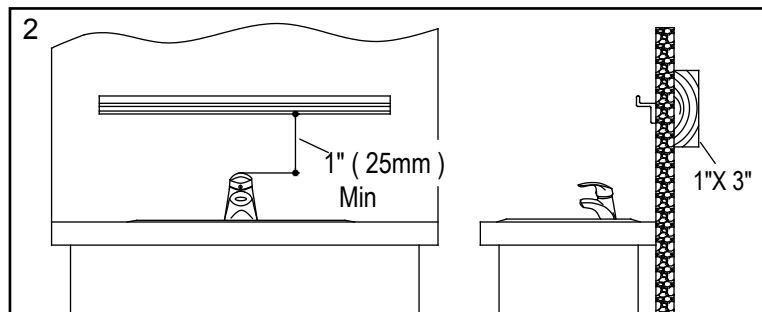
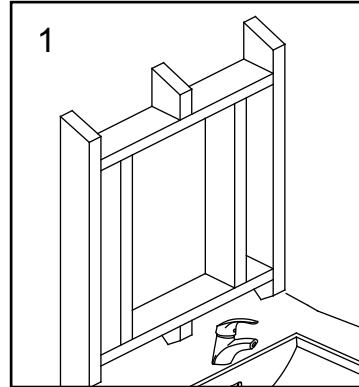

3. Once you are sure that mounting bar (H) is centered and level, drill (3) 7/32 " holes on the indented part of the mounting bar (H). Drill 9/32 " holes for anchors (E). Use 3 screws (F) along with anchors (E) and affix mounting bar (H) to the wall.

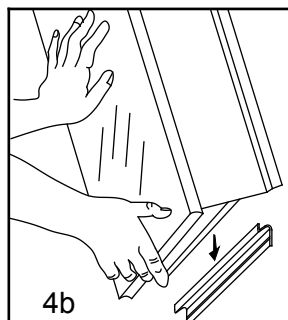
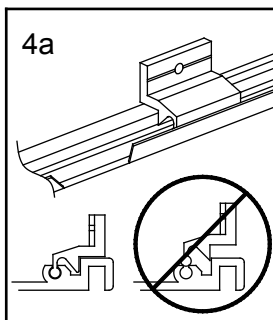
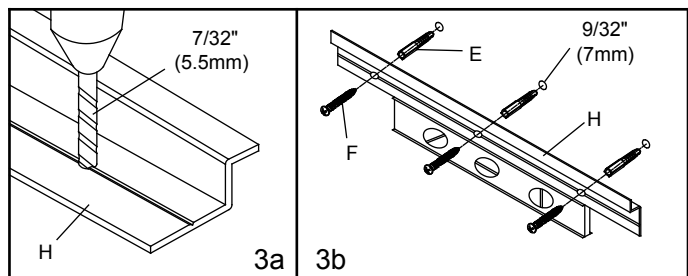

4. Slide in the (2) mounting clips (G) into the slot on top of the cabinet box. Lift cabinet box and place in to slot of mounting bar (H), hold cabinet box against wall. Drill 9/32 " hole for anchors (E), space out evenly and install screws (F) and anchors (E) to hold mounting clips (G) and cabinet box in place.

Final Assembly Instructions continued

1. Re-mount the door removed earlier onto the cabinet box. **Warning: Door will swing open 155 degrees.** To make door swing 110 degrees in case wall in close by please use reduction clips (D).

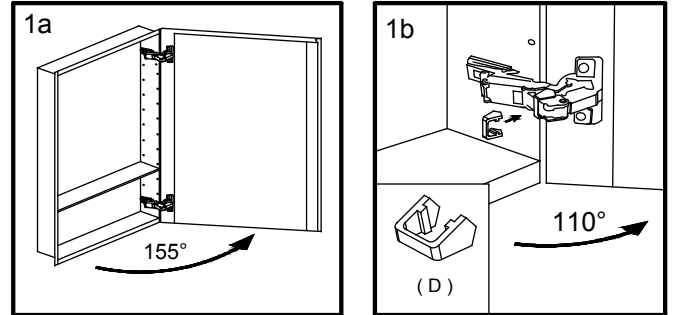
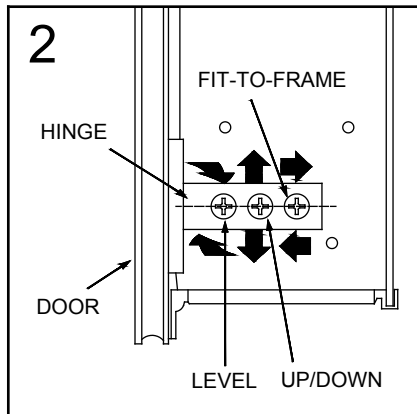

2. The hinges on the door are 3-way adjustable S/C hinges allowing you the fit it accordingly with the cabinet box.

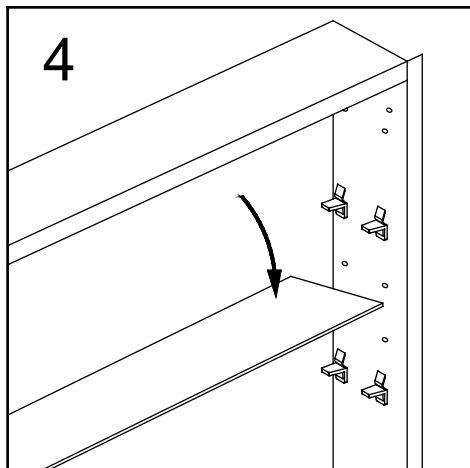
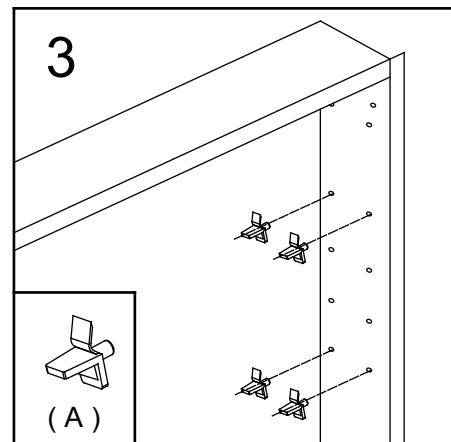

4. Snap in glass shelves (I) one side at a time making sure the glass shelves (I) are snug before releasing.

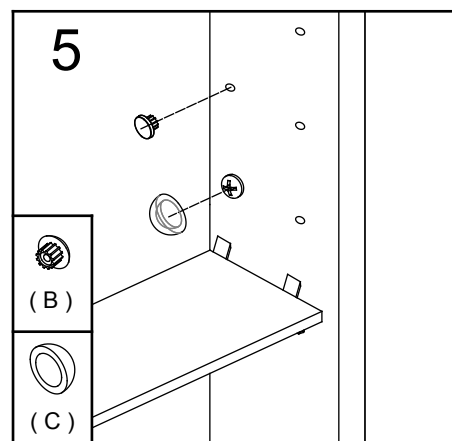

5. Fill-in remaining holes with provided hole plugs (B) for cleaner look. Use screw caps (C) to cover any screw heads used from mounting optional side kit.

Side Kit Installation Guide (Optional side kits sold separately)

Parts

Please locate and be sure all parts are present prior to installation.



(8) Screws (J)

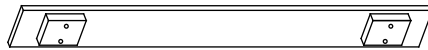

(2) Side Kits (K)



(8) Screw Caps (C)

1. Attach side kit using screws (J) from the inside of the box into the side kits.
2. Make sure side kits are secured before completing installation.
3. Use screw caps (C) to cover up screw heads for cleaner appearance.

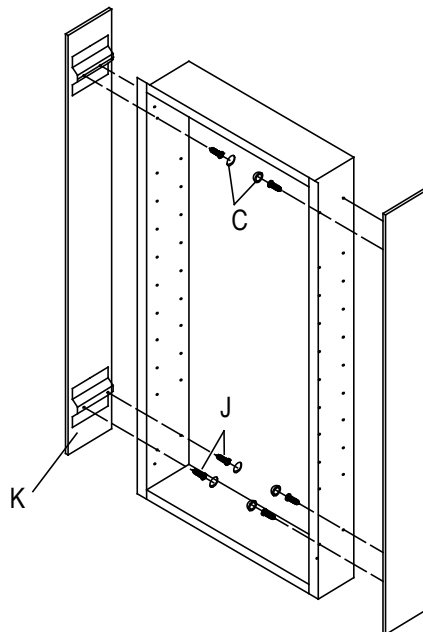

Maintenance and Warranty Information

The medicine cabinet is made up of aluminum, wood, and mirrored glass.

Using a damp cloth is the best way to wipe down medicine cabinet.

DO NOT USE AMMONIA OR VINEGAR BASED PRODUCTS

Recommended even blend of isopropyl alcohol and water should be used to clean mirrored glass.

When cleaning cabinet make sure to use cleaning solution on the cloth and not directly onto the cabinet.

Do not use any abrasive material on any part of the medicine cabinet

Do not place any items behind the hinges of the cabinet door to prevent damage to mirrors or items when door is closed and hinges are folded.

Dickson warrants the original purchaser within one-year of purchase with original receipt with date of delivery. Warranty is void if products are damaged in transit, misuse or abuse of the product, accidental damage, improper installation, and/or improper maintenance. After one-year warranty period **Dickson** is no longer liable for any warranty or replacement.